

Instructions for modifying Watson and Brookman induction hopper to accomodate 2 container wash nozzles

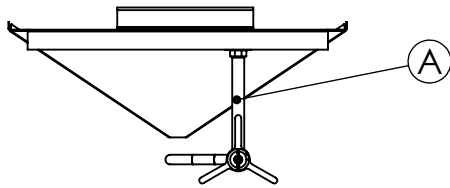

Remove hopper from mounting

Remove existing valve "A"

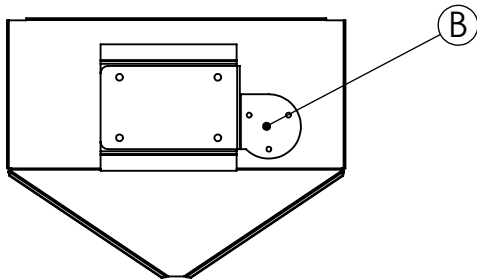

Bolt plate "B" onto mounting plate and drill 3 off 6.5mm dia holes through hopper back

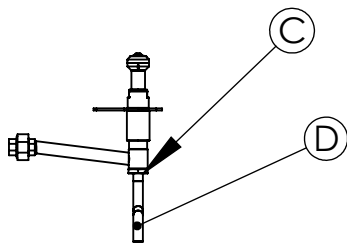

Unscrew base nut and tube from bottom of existing valve "A" replace with new base nut "C" and tube "D"

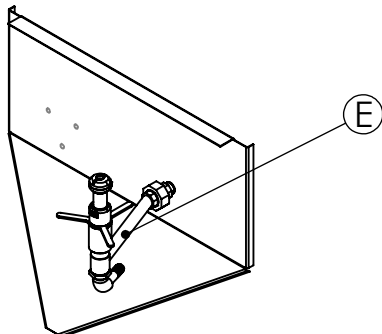

Fit new container wash valve "E" to existing valve spigot

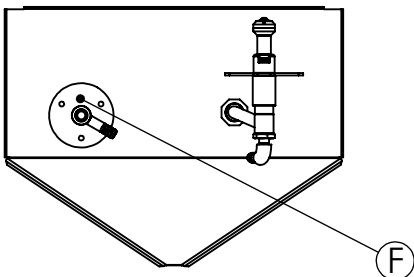

Bolt valve spigot "F" through hopper and mounting plate "B" with 3 off M6 bolts provided

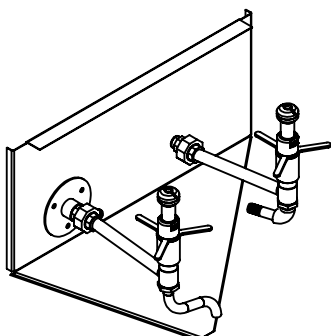

Fit valve "A" onto new valve spigot "F"

Parts list - PC-CW550 (Centre feed hopper) and PC-CW551 (Off-centre feed)

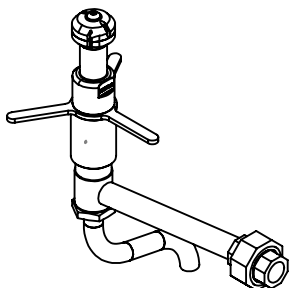

Container wash valve "A"
This is the original can wash from the hopper
The bottom tube will need to be unscrewed

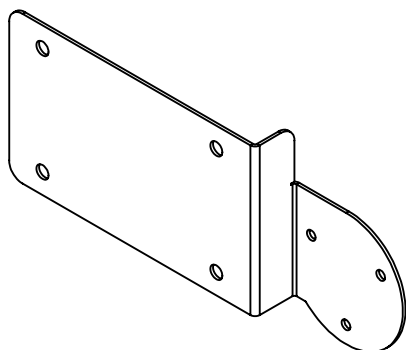

Back plate "B"



Base nut "C"

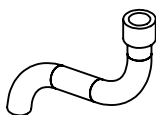

Base Tube "D"

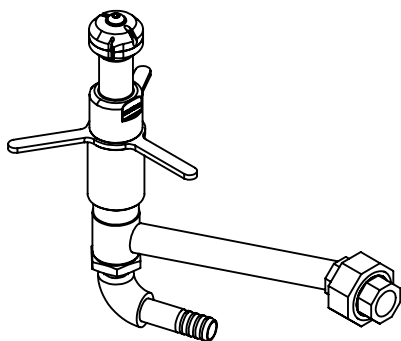

New container wash valve "E"

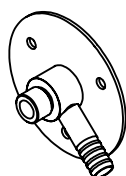

Valve spigot "F"